

Keola Lai 600 Queen Street Unit 2003, Honolulu 96813 * Keola Lai * \$795,000

Sold Price: \$780,000

Sold Date: 09-04-2020

Sold Ratio: 98%

Beds: **2**

MLS#: **202015448, FS**

Year Built: **2008**

Bath: **2/0**

Status: **Sold**

Remodeled:

Living Sq. Ft.: **993**

List Date & DOM: **07-03-2020 & 8**

Total Parking: **2**

Land Sq. Ft.: **0**

Condition: **Excellent**

[Assessed Value](#)

Lanai Sq. Ft.: **86**

Frontage:

Building: **\$661,500**

Sq. Ft. Other: **0**

Tax/Year: **\$215/2019**

Land: **\$76,100**

Total Sq. Ft. **1,079**

Neighborhood: **Kakaako**

Total: **\$737,600**

Maint./Assoc. **\$932 / \$0**

[Flood Zone](#): **Zone X - Tool**

Stories / CPR: **21+ / No**

Parking: **Covered - 2**

Frontage:

[Zoning](#): **KA - State jurisdiction, refer**

View: **City, Coastline, Ocean, Sunset**

Public Remarks: Luxury 2/2/2 end unit in Kakaako. Stunning lanai and floor to ceiling ocean, harbor, city and sunset views. Open floor plan with dramatic 8'6" ceilings, central AC, granite counter tops, porcelain kitchen and bathroom floors, solid maple cabinets, washer/dryer, separate dining area, spacious walk in closet. Fresh paint. New fridge, dishwasher. Resort-like amenities include jacuzzi, heated pool, BBQs, fitness center bike/surfboard storage, in/outdoor entertainment areas, EV charging station, ample guest parking spaces, 24hr security guard, video surveillance. Key fob required to enter parking garage, lobby and elevators. Walking distance to Downtown, SALT, Whole Foods, Down to Earth, Blaisdell, Ala Moana. Balconies are rarely available in Keola Lai. Pet friendly. Shown by appointment only. **Sale Conditions:** None **Schools:** [Royal, Central, Mckinley](#) * [Request Showing, Photos, History, Maps, Deed, Watch List, Tax Info](#)

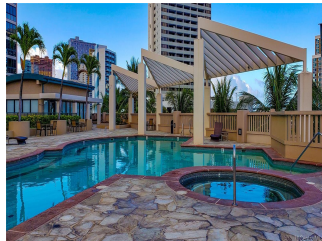
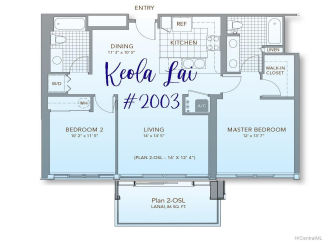
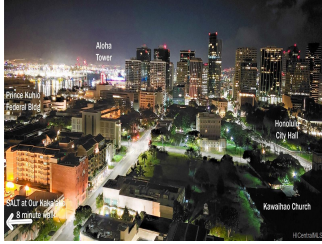



Address	Price	Bd & Bth	Living / Avg.	Land Avg.	Lanai	Occ.	FL	DOM
600 Queen Street 2003	\$795,000	2 & 2/0	993 \$801	0 \$inf	86	57%	20	8

Address	Tax Maint. Ass.	Assessed Land	Assessed Building	Assessed Total	Ratio	Year & Remodeled
600 Queen Street 2003	\$215 \$932 \$0	\$76,100	\$661,500	\$737,600	108%	2008 & NA

Address	Sold Price	Sold Date	Sold Ratio	Original Ratio	Sold Terms
600 Queen Street 2003	\$780,000	09-04-2020	98%	98%	VA

[600 Queen Street 2003](#) - MLS#: [202015448](#) - Luxury 2/2/2 end unit in Kakaako. Stunning lanai and floor to ceiling ocean, harbor, city and sunset views. Open floor plan with dramatic 8'6" ceilings, central AC, granite counter tops, porcelain kitchen and bathroom floors, solid maple cabinets, washer/dryer, separate dining area, spacious walk in closet. Fresh paint. New fridge, dishwasher. Resort-like amenities include jacuzzi, heated pool, BBQs, fitness center bike/surfboard storage, in/outdoor entertainment areas, EV charging station, ample guest parking spaces, 24hr security guard, video surveillance. Key fob required to enter parking garage, lobby and elevators. Walking distance to Downtown, SALT, Whole Foods, Down to Earth, Blaisdell, Ala Moana. Balconies are rarely available in Keola Lai. Pet friendly. Shown by appointment only. **Region:** Metro **Neighborhood:** Kakaako **Condition:** Excellent **Parking:** Covered - 2 **Total Parking:** 2 **View:** City, Coastline, Ocean, Sunset **Frontage:** **Pool:** **Zoning:** KA - State jurisdiction, refer **Sale Conditions:** None **Schools:** [Royal](#), [Central](#), [Mckinley](#) * [Request Showing](#), [Photos](#), [History](#), [Maps](#), [Deed](#), [Watch List](#), [Tax Info](#)

DOM = Days on Market, Occ. = Occupancy, FL = Floor Number