

Hale Ka Lae 7000 Hawaii Kai Drive Unit 3301, Honolulu 96825 * Hale Ka Lae * \$706,000

Sold Price: \$706,000	Sold Date: 10-23-2020	Sold Ratio: 100%
Beds: 4	MLS#: 202023596, FS	Year Built: 2016
Bath: 2/0	Status: Sold	Remodeled:
Living Sq. Ft.: 1,154	List Date & DOM: 09-10-2020 & 15	Total Parking: 2
Land Sq. Ft.: 0	Condition: Excellent	Assessed Value
Lanai Sq. Ft.: 0	Frontage:	Building: \$0
Sq. Ft. Other: 0	Tax/Year: \$221/2020	Land: \$0
Total Sq. Ft. 1,154	Neighborhood: West Marina	Total: \$759,000
Maint./Assoc. \$646 / \$0	Flood Zone : Zone D - Tool	Stories / CPR: One / No
Parking: Covered - 2	Frontage:	
Zoning : 12 - A-2 Medium Density Apartme	View: None, Mountain	

Public Remarks: Priced below assessed value! "Flex" unit with 4-bedrooms and 2-bathrooms. This "flex" floor plan type has an ADU feature in which one side features 2-bedrooms, 1-bathroom that has a wet bar and full cabinetry system separate from the other 2-bedroom, 1-bathroom side. This is a newer building located in Hawaii Kai Marina Community with many amenities. Hale Ka Lae features over an acre of gated green open space with a private playground, large salt water pool, hot tub, picnic cabanas, party rooms, movie room, meeting rooms, fitness center, and onsite management. Located close to shopping centers, Costco, restaurants, hiking trails, Hanauma Bay, and more! *Pictures may not reflect actual unit **Sale Conditions:** None **Schools:** [Hahaione](#), [Niu Valley](#), [Kaiser](#) * [Request Showing](#), [Photos](#), [History](#), [Maps](#), [Deed](#), [Watch List](#), [Tax Info](#)

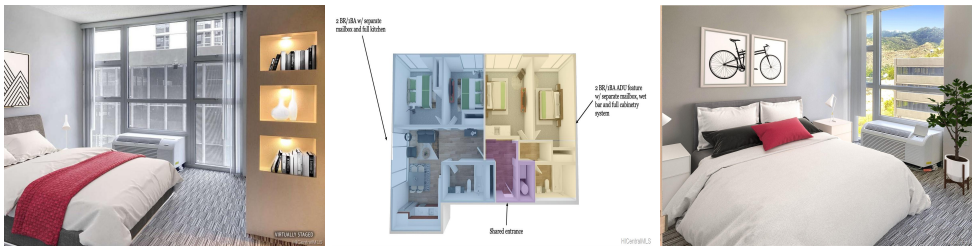

Address	Price	Bd & Bth	Living / Avg.	Land Avg.	Lanai	Occ.	FL	DOM
7000 Hawaii Kai Drive 3301	\$706,000	4 & 2/0	1,154 \$612	0 \$inf	0	0%	3	15

Address	Tax Maint. Ass.	Assessed Land	Assessed Building	Assessed Total	Ratio	Year & Remodeled
7000 Hawaii Kai Drive 3301	\$221 \$646 \$0	\$0	\$0	\$759,000	93%	2016 & NA

Address	Sold Price	Sold Date	Sold Ratio	Original Ratio	Sold Terms
7000 Hawaii Kai Drive 3301	\$706,000	10-23-2020	100%	100%	Cash

[7000 Hawaii Kai Drive 3301](#) - MLS#: [202023596](#) - Priced below assessed value! "Flex" unit with 4-bedrooms and 2-bathrooms. This "flex" floor plan type has an ADU feature in which one side features 2-bedrooms, 1-bathroom that has a wet bar and full cabinetry system separate from the other 2-bedroom, 1-bathroom side. This is a newer building located in Hawaii Kai Marina Community with many amenities. Hale Ka Lae features over an acre of gated green open space with a private playground, large salt water pool, hot tub, picnic cabanas, party rooms, movie room, meeting rooms, fitness center, and onsite management. Located close to shopping centers, Costco, restaurants, hiking trails, Hanauma Bay, and more! *Pictures may not reflect actual unit **Region:** Hawaii Kai **Neighborhood:** West Marina **Condition:** Excellent **Parking:** Covered - 2 **Total Parking:** 2 **View:** None, Mountain **Frontage:** **Pool:** **Zoning:** 12 - A-2 Medium Density Apartme **Sale Conditions:** None **Schools:** [Hahaione](#), [Niu Valley](#), [Kaiser](#) * [Request Showing](#), [Photos](#), [History](#), [Maps](#), [Deed](#), [Watch List](#), [Tax Info](#)

DOM = Days on Market, Occ. = Occupancy, FL = Floor Number