

Hale Ka Lae 7000 Hawaii Kai Drive Unit 2611, Honolulu 96825 * Hale Ka Lae * \$709,000 *

Originally \$740,000

Sold Price: \$709,000	Sold Date: 12-24-2020	Sold Ratio: 100%
Beds: 3	MLS#: 202029485, FS	Year Built: 2016
Bath: 2/0	Status: Sold	Remodeled:
Living Sq. Ft.: 1,145	List Date & DOM: 11-16-2020 & 3	Total Parking: 2
Land Sq. Ft.: 0	Condition: Excellent	Assessed Value
Lanai Sq. Ft.: 0	Frontage: Other	Building: \$631,700
Sq. Ft. Other: 0	Tax/Year: \$225/2020	Land: \$118,100
Total Sq. Ft. 1,145	Neighborhood: West Marina	Total: \$749,800
Maint./Assoc. \$641 / \$0	Flood Zone : Zone D - Tool	Stories / CPR: 8-14 / No
Parking: Covered - 2	Frontage: Other	
Zoning : 12 - A-2 Medium Density Apartme	View: Garden	

Public Remarks: Better living starts here! New building with up to date sprinklers and fire alarms. Flexible 3br/2ba layout with two covered parking stalls, designed for multi-generational families looking to extend their living area by keeping your loved ones close or flexibility to be an owner-occupant with the opportunity to earn rental income. The VALUE is in the FLEXibility. In these times of uncertainty, the flex unit can offer an unbeatable value with two separate mail boxes (addresses). Hale Ka Lae is a newer unique building with resort-like amenities while enjoying the Hawaii Kai lifestyle. Situated in a neighborhood with close proximity to beaches, parks and hiking trails, shopping centers, restaurants, Costco, and more!

Pictures are staged and may not reflect the actual unit ** Original Price listed in error. **Sale Conditions:** None **Schools:** [Hahaione](#), [Niu Valley](#), [Kaiser](#) * [Request Showing](#), [Photos](#), [History](#), [Maps](#), [Deed](#), [Watch List](#), [Tax Info](#)

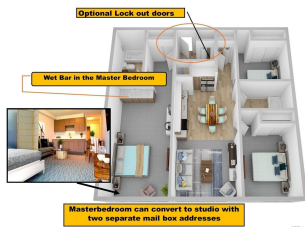

Address	Price	Bd & Bth	Living / Avg.	Land Avg.	Lanai	Occ.	FL	DOM
7000 Hawaii Kai Drive 2611	\$709,000	3 & 2/0	1,145 \$619	0 \$inf	0	53%	6	3

Address	Tax Maint. Ass.	Assessed Land	Assessed Building	Assessed Total	Ratio	Year & Remodeled
7000 Hawaii Kai Drive 2611	\$225 \$641 \$0	\$118,100	\$631,700	\$749,800	95%	2016 & NA

Address	Sold Price	Sold Date	Sold Ratio	Original Ratio	Sold Terms
7000 Hawaii Kai Drive 2611	\$709,000	12-24-2020	100%	96%	Cash

[7000 Hawaii Kai Drive 2611](#) - MLS#: [202029485](#) - Original price was \$740,000 - Better living starts here! New building with up to date sprinklers and fire alarms. Flexible 3br/2ba layout with two covered parking stalls, designed for multi-generational families looking to extend their living area by keeping your loved ones close or flexibility to be an owner-occupant with the opportunity to earn rental income. The VALUE is in the FLEXibility. In these times of uncertainty, the flex unit can offer an unbeatable value with two separate mail boxes (addresses). Hale Ka Lae is a newer unique building with resort-like amenities while enjoying the Hawaii Kai lifestyle. Situated in a neighborhood with close proximity to beaches, parks and hiking trails, shopping centers, restaurants, Costco, and more! *Pictures are staged and may not reflect the actual unit* ** Original Price listed in error. **Region:** Hawaii Kai **Neighborhood:** West Marina **Condition:** Excellent **Parking:** Covered - 2 **Total Parking:** 2 **View:** Garden **Frontage:** Other **Pool:** **Zoning:** 12 - A-2 Medium Density Apartme **Sale Conditions:** None **Schools:** [Hahaione](#), [Niu Valley](#), [Kaiser](#) * [Request Showing](#), [Photos](#), [History](#), [Maps](#), [Deed](#), [Watch List](#), [Tax Info](#)

DOM = Days on Market, Occ. = Occupancy, FL = Floor Number