

# Hale Ka Lae 7000 Hawaii Kai Drive Unit 2410, Honolulu 96825 \* Hale Ka Lae \* \$807,100 \*

Originally \$775,000

Sold Price: \$807,100	Sold Date: 06-16-2021	Sold Ratio: 100%
Beds: <b>2</b>	MLS#: <b>202109806, FS</b>	Year Built: <b>2016</b>
Bath: <b>2/0</b>	Status: <b>Sold</b>	Remodeled:
Living Sq. Ft.: <b>1,145</b>	List Date & DOM: <b>04-23-2021 &amp;</b>	Total Parking: <b>2</b>
Land Sq. Ft.: <b>0</b>	Condition: <b>Excellent</b>	<a href="#">Assessed Value</a>
Lanai Sq. Ft.: <b>0</b>	Frontage: <b>Other</b>	Building: <b>\$599,600</b>
Sq. Ft. Other: <b>0</b>	Tax/Yr: <b>\$224/2020</b>	Land: <b>\$124,200</b>
Total Sq. Ft. <b>1,145</b>	Neighborhood: <b>West Marina</b>	Total: <b>\$723,800</b>
Maint./Assoc. <b>\$641 / \$0</b>	<a href="#">Flood Zone</a> : <b>Zone D - Tool</b>	Stories / CPR: <b>8-14 / No</b>
Parking: <b>Covered - 2</b>	Frontage: <b>Other</b>	
<a href="#">Zoning</a> : <b>12 - A-2 Medium Density Apartme</b>	View: <b>Garden</b>	

**Public Remarks:** This 2 bd/1 LARGE den/2 ba unique flex-unit design allows one condominium unit the FLEXIBILITY to function like two condos: one side has 2 rooms, one bath and a full kitchen. Locked with a separate key. Middle area is a shared foyer with shared entry, shared 50 gallon water heater system and a washer/dryer area. The other side is a very large master suite with a full bath and a fully built wet-bar and kitchen cabinetry to function as a studio unit. Unit includes two parking stalls with opportunity to purchase a 3rd stall and onsite storage unit. Unit is assigned two unit numbers and two mail boxes. Must see to appreciate. Built in 2016. Fire sprinklers in every room. All in-unit air conditioners are separate PTAC systems and are not connected to other units. This unit won't last long! **Sale Conditions:** None **Schools:** [Hahaione](#), [Niu Valley](#), [Kaiser](#) \* [Request Showing](#), [Photos](#), [History](#), [Maps](#), [Deed](#), [Watch List](#), [Tax Info](#)

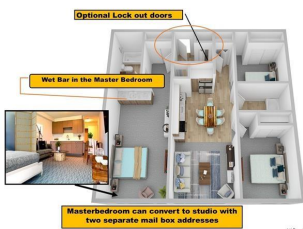

Address	Price	Bd & Bth	Living / Avg.	Land   Avg.	Lanai	Occ.	FL	DOM
<a href="#">7000 Hawaii Kai Drive 2410</a>	<b>\$807,100</b>	2 & 2/0	1,145   \$705	0   \$inf	0	53%	4	0

Address	Tax   Maint.   Ass.	Assessed Land	Assessed Building	Assessed Total	Ratio	Year & Remodeled
<a href="#">7000 Hawaii Kai Drive 2410</a>	\$224   \$641   \$0	\$124,200	\$599,600	\$723,800	112%	2016 & NA

Address	Sold Price	Sold Date	Sold Ratio	Original Ratio	Sold Terms
<a href="#">7000 Hawaii Kai Drive 2410</a>	\$807,100	06-16-2021	100%	104%	Other

[7000 Hawaii Kai Drive 2410](#) - MLS#: [202109806](#) - Original price was \$775,000 - This 2 bd/1 LARGE den/2 ba unique flex-unit design allows one condominium unit the FLEXIBILITY to function like two condos: one side has 2 rooms, one bath and a full kitchen. Locked with a separate key. Middle area is a shared foyer with shared entry, shared 50 gallon water heater system and a washer/dryer area. The other side is a very large master suite with a full bath and a fully built wet-bar and kitchen cabinetry to function as a studio unit. Unit includes two parking stalls with opportunity to purchase a 3rd stall and onsite storage unit. Unit is assigned two unit numbers and two mail boxes. Must see to appreciate. Built in 2016. Fire sprinklers in every room. All in-unit air conditioners are separate PTAC systems and are not connected to other units. This unit won't last long! **Region:** Hawaii Kai **Neighborhood:** West Marina **Condition:** Excellent **Parking:** Covered - 2 **Total Parking:** 2 **View:** Garden **Frontage:** Other **Pool:** **Zoning:** 12 - A-2 Medium Density Apartme **Sale Conditions:** None **Schools:** [Hahaione](#), [Niu Valley](#), [Kaiser](#) \* [Request Showing](#), [Photos](#), [History](#), [Maps](#), [Deed](#), [Watch List](#), [Tax Info](#)

DOM = Days on Market, Occ. = Occupancy, FL = Floor Number