

Hale Ka Lae 7000 Hawaii Kai Drive Unit 2803, Honolulu 96825 * Hale Ka Lae * \$749,500 *

Originally \$740,000

Sold Price: \$749,500	Sold Date: 06-16-2021	Sold Ratio: 100%
Beds: 2	MLS#: 202109827 , FS	Year Built: 2016
Bath: 2/0	Status: Sold	Remodeled:
Living Sq. Ft.: 1,145	List Date & DOM: 04-23-2021 & 3	Total Parking: 2
Land Sq. Ft.: 0	Condition: Excellent	Assessed Value
Lanai Sq. Ft.: 0	Frontage: Other	Building: \$606,500
Sq. Ft. Other: 0	Tax/Year: \$226/2020	Land: \$124,200
Total Sq. Ft. 1,145	Neighborhood: West Marina	Total: \$730,700
Maint./Assoc. \$641 / \$0	Flood Zone : Zone D - Tool	Stories / CPR: 8-14 / No
Parking: Covered - 2	Frontage: Other	
Zoning : 12 - A-2 Medium Density Apartme	View: Mountain	

Public Remarks: This 2 bd/1 LARGE den/2 ba unique flex-unit design allows one condominium unit the FLEXIBILITY to function like two condos: one side has 2 rooms, one bath and a full kitchen. Locked with a separate key. Middle area is a shared foyer with shared entry, shared 50 gallon water heater system and a washer/dryer area. The other side is a very large master suite with a full bath and a fully built wet-bar and kitchen cabinetry to function as a studio unit. Unit includes two parking stalls with opportunity to purchase a 3rd stall and onsite storage unit. Unit is assigned two unit numbers and two mail boxes. Must see to appreciate. Built in 2016. Fire sprinklers in every room. All in-unit air conditioners are separate PTAC systems and are not connected to other units. This unit won't last long! **Sale Conditions:** None **Schools:** [Hahaione](#), [Niu Valley](#), [Kaiser](#) * [Request Showing](#), [Photos](#), [History](#), [Maps](#), [Deed](#), [Watch List](#), [Tax Info](#)

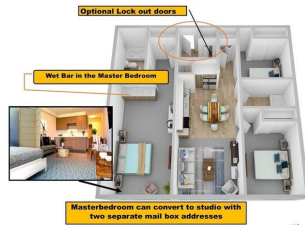

Address	Price	Bd & Bth	Living / Avg.	Land Avg.	Lanai	Occ.	FL	DOM
7000 Hawaii Kai Drive 2803	\$749,500	2 & 2/0	1,145 \$655	0 inf	0	53%	8	3

Address	Tax Maint. Ass.	Assessed Land	Assessed Building	Assessed Total	Ratio	Year & Remodeled
7000 Hawaii Kai Drive 2803	\$226 \$641 \$0	\$124,200	\$606,500	\$730,700	103%	2016 & NA

Address	Sold Price	Sold Date	Sold Ratio	Original Ratio	Sold Terms
7000 Hawaii Kai Drive 2803	\$749,500	06-16-2021	100%	101%	Other

[7000 Hawaii Kai Drive 2803](#) - MLS#: [202109827](#) - Original price was \$740,000 - This 2 bd/1 LARGE den/2 ba unique flex-unit design allows one condominium unit the FLEXIBILITY to function like two condos: one side has 2 rooms, one bath and a full kitchen. Locked with a separate key. Middle area is a shared foyer with shared entry, shared 50 gallon water heater system and a washer/dryer area. The other side is a very large master suite with a full bath and a fully built wet-bar and kitchen cabinetry to function as a studio unit. Unit includes two parking stalls with opportunity to purchase a 3rd stall and onsite storage unit. Unit is assigned two unit numbers and two mail boxes. Must see to appreciate. Built in 2016. Fire sprinklers in every room. All in-unit air conditioners are separate PTAC systems and are not connected to other units. This unit won't last long! **Region:** Hawaii Kai **Neighborhood:** West Marina **Condition:** Excellent **Parking:** Covered - 2 **Total Parking:** 2 **View:** Mountain **Frontage:** Other **Pool:** **Zoning:** 12 - A-2 Medium Density Apartme **Sale Conditions:** None **Schools:** [Hahaione](#), [Niu Valley](#), [Kaiser](#) * [Request Showing](#), [Photos](#), [History](#), [Maps](#), [Deed](#), [Watch List](#), [Tax Info](#)

DOM = Days on Market, Occ. = Occupancy, FL = Floor Number