

**Plaza Hawaii Kai 6770 Hawaii Kai Drive Unit 804, Honolulu 96825 \* Plaza Hawaii Kai \***

**\$569,000**

Sold Price: \$570,000	Sold Date: 10-21-2021	Sold Ratio: 100%
Beds: <b>2</b>	MLS#: <b><u>202123512</u></b> , FS	Year Built: <b>1974</b>
Bath: <b>2/0</b>	Status: <b>Sold</b>	Remodeled: <b>2021</b>
Living Sq. Ft.: <b>1,030</b>	List Date & DOM: <b>09-09-2021 &amp; 7</b>	Total Parking: <b>2</b>
Land Sq. Ft.: <b>125,583</b>	Condition: <b>Excellent</b>	<a href="#">Assessed Value</a>
Lanai Sq. Ft.: <b>0</b>	Frontage: <b>Other</b>	Building: <b>\$403,700</b>
Sq. Ft. Other: <b>0</b>	Tax/Year: <b>\$116/2021</b>	Land: <b>\$134,700</b>
Total Sq. Ft. <b>1,030</b>	Neighborhood: <b>Hahaione-lower</b>	Total: <b>\$538,400</b>
Maint./Assoc. <b>\$1,042 / \$0</b>	<a href="#">Flood Zone</a> : <b>Zone D - Tool</b>	Stories / CPR: / <b>No</b>
Parking: <b>Assigned, Covered - 2, Guest, Street</b>	Frontage: <b>Other</b>	
<a href="#">Zoning</a> : <b>12 - A-2 Medium Density Apartme</b>	View: <b>Mountain, Ocean, Sunset</b>	

**Public Remarks:** Come enjoy the indoor-outdoor living at Plaza Hawaii Kai featuring beautiful views of Koko Head and the ocean waters of Maunalua Bay. This spacious, rarely available "04" stack, 2 bedroom, 2 bath condo comes with 2 full-sized covered parking spaces, a large storage locker, and an open lanai. Recent upgrades include refreshed bathrooms and flooring. Amenities-pool, gym, BBQ, guest parking. Plaza Hawaii Kai is a secure, well-managed, pet-friendly high-rise. Located a short distance to all that the Hawaii Kai community has to offer...shopping, restaurants, Costco, supermarkets, International Baccalaureate public schools, and more. **Sale Conditions:** None **Schools:** [Hahaione](#), [Niu Valley](#), [Kaiser](#) \* [Request Showing](#), [Photos](#), [History](#), [Maps](#), [Deed](#), [Watch List](#), [Tax Info](#)

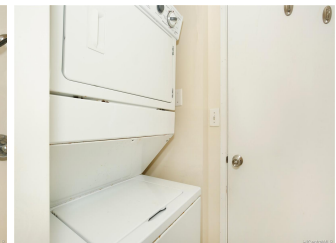
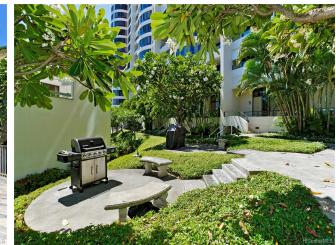

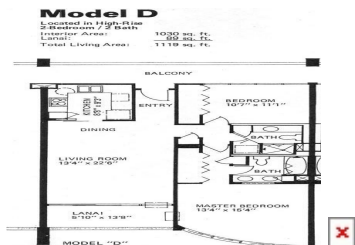

Address	Price	Bd & Bth	Living / Avg.	Land   Avg.	Lanai	Occ.	FL	DOM
<a href="#">6770 Hawaii Kai Drive 804</a>	<a href="#">\$569,000</a>	2 & 2/0	1,030   \$552	125,583   \$5	0	64%	8	7

Address	Tax   Maint.   Ass.	Assessed Land	Assessed Building	Assessed Total	Ratio	Year & Remodeled
<a href="#">6770 Hawaii Kai Drive 804</a>	\$116   \$1,042   \$0	\$134,700	\$403,700	\$538,400	106%	1974 & 2021

Address	Sold Price	Sold Date	Sold Ratio	Original Ratio	Sold Terms
<a href="#">6770 Hawaii Kai Drive 804</a>	\$570,000	10-21-2021	100%	100%	Cash

[6770 Hawaii Kai Drive 804](#) - MLS#: [202123512](#) - Come enjoy the indoor-outdoor living at Plaza Hawaii Kai featuring beautiful views of Koko Head and the ocean waters of Maunaloa Bay. This spacious, rarely available "04" stack, 2 bedroom, 2 bath condo comes with 2 full-sized covered parking spaces, a large storage locker, and an open lanai. Recent upgrades include refreshed bathrooms and flooring. Amenities-pool, gym, BBQ, guest parking. Plaza Hawaii Kai is a secure, well-managed, pet-friendly high-rise. Located a short distance to all that the Hawaii Kai community has to offer...shopping, restaurants, Costco, supermarkets, International Baccalaureate public schools, and more. **Region:** Hawaii Kai **Neighborhood:** Hahaione-lower **Condition:** Excellent **Parking:** Assigned, Covered - 2, Guest, Street **Total Parking:** 2 **View:** Mountain, Ocean, Sunset **Frontage:** Other **Pool:** **Zoning:** 12 - A-2 Medium Density Apartme **Sale Conditions:** None **Schools:** [Hahaione](#), [Niu Valley](#), [Kaiser](#) \* [Request Showing](#), [Photos](#), [History](#), [Maps](#), [Deed](#), [Watch List](#), [Tax Info](#)

DOM = Days on Market, Occ. = Occupancy, FL = Floor Number