

# Ala Moana Hotel Condo 410 Atkinson Drive Unit 2802, Honolulu 96814 \* Ala Moana Hotel

Condo \* \$235,000

Beds: <b>0</b>	MLS#: <b>202326443, FS</b>	Year Built: <b>1970</b>
Bath: <b>1/0</b>	Status: <b>Active</b>	Remodeled:
Living Sq. Ft.: <b>297</b>	List Date & DOM: <b>12-07-2023 &amp; 154</b>	Total Parking: <b>0</b>
Land Sq. Ft.: <b>0</b>	Condition: <b>Excellent</b>	<a href="#">Assessed Value</a>
Lanai Sq. Ft.: <b>48</b>	Frontage:	Building: <b>\$178,900</b>
Sq. Ft. Other: <b>0</b>	Tax/Year: <b>\$242/2023</b>	Land: <b>\$60,100</b>
Total Sq. Ft. <b>345</b>	Neighborhood: <b>Ala Moana</b>	Total: <b>\$239,000</b>
Maint./Assoc. <b>\$1,206 / \$0</b>	<a href="#">Flood Zone</a> : <b>Zone AE - Tool</b>	Stories / CPR: / No
Parking: <b>None</b>	Frontage:	
<a href="#">Zoning</a> : <b>33 - BMX-3 Community Business M</b>	View: <b>City, Coastline, Ocean, Sunset</b>	

**Public Remarks:** Experience the luxury of multimillion-dollar transformation! Ala Moana Hotel Condo has all the amenities of a first-class hotel and located next to the Ala Moana Shopping Center, one of the largest outdoor malls in the U.S! Conveniently located across the street from Ala Moana Beach Park where you can relax on the beach or surf some of the best waves on the island. Ala Moana Hotel offers a rental program so that you can generate income between the periods you're not using it. This is your opportunity to invest in a piece of paradise that you can use on vacation. The studio is furnished with a King bed and pull-out sofa. Maintenance fee includes A/C, Cable TV, Electricity, Internet, and water. Amenities also includes state-of-the-art fitness center with sauna, steam room and pool. **Sale Conditions:** None **Schools:** , , \* [Request Showing](#), [Photos](#), [History](#), [Maps](#), [Deed](#), [Watch List](#), [Tax Info](#)

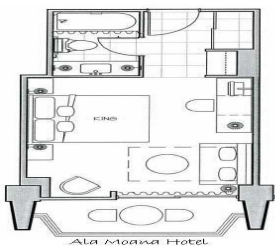

Address	Price	Bd & Bth	Living / Avg.	Land   Avg.	Lanai	Occ.	FL	DOM
<a href="#">410 Atkinson Drive 2802</a>	<a href="#">\$235,000</a>	0 & 1/0	297   \$791	0   inf	48	0%	28	154

Address	Tax   Maint.   Ass.	Assessed Land	Assessed Building	Assessed Total	Ratio	Year & Remodeled
<a href="#">410 Atkinson Drive 2802</a>	\$242   \$1,206   \$0	\$60,100	\$178,900	\$239,000	98%	1970 & NA

[410 Atkinson Drive 2802](#) - MLS#: [202326443](#) - Experience the luxury of multimillion-dollar transformation! Ala Moana Hotel Condo has all the amenities of a first-class hotel and located next to the Ala Moana Shopping Center, one of the largest outdoor malls in the U.S! Conveniently located across the street from Ala Moana Beach Park where you can relax on the beach or surf some of the best waves on the island. Ala Moana Hotel offers a rental program so that you can generate income between the periods you're not using it. This is your opportunity to invest in a piece of paradise that you can use on vacation. The studio is furnished with a King bed and pull-out sofa. Maintenance fee includes A/C, Cable TV, Electricity, Internet, and water. Amenities also includes state-of-the-art fitness center with sauna, steam room and pool. **Region:** Metro **Neighborhood:** Ala Moana **Condition:** Excellent **Parking:** None **Total Parking:** 0 **View:** City, Coastline, Ocean, Sunset **Frontage:** **Pool:** **Zoning:** 33 - BMX-3 Community Business M **Sale Conditions:** None **Schools:** , , \* [Request Showing](#), [Photos](#), [History](#), [Maps](#), [Deed](#), [Watch List](#), [Tax Info](#)

DOM = Days on Market, Occ. = Occupancy, FL = Floor Number