

Hale O Pumehana 757 Kinalau Place Unit 1503, Honolulu 96813 * Hale O Pumehana *

\$398,000 * Originally \$428,000

Beds: 2	MLS#: 202400417, FS	Year Built: 1975
Bath: 2/0	Status: Active	Remodeled:
Living Sq. Ft.: 786	List Date & DOM: 01-06-2024 & 125	Total Parking: 1
Land Sq. Ft.: 27,748	Condition: Above Average	Assessed Value
Lanai Sq. Ft.: 78	Frontage:	Building: \$385,600
Sq. Ft. Other: 0	Tax/Year: \$104/2024	Land: \$69,400
Total Sq. Ft. 864	Neighborhood: Punchbowl-lower	Total: \$455,000
Maint./Assoc. \$934 / \$0	Flood Zone : Zone X - Tool	Stories / CPR: 15-20 / No
Parking: Assigned, Guest, Open - 1, Secured Entry, Street	Frontage:	
Zoning : 12 - A-2 Medium Density Apartme	View: City, Mountain, Ocean, Sunset	

Public Remarks: PRICE REDUCED! Motivated Sellers. One of the lowest 2/2/1 unit priced in the area! Only unit on the market in the building! Moving-in condition! Building plumbing and fire alarm had been updated recently. This improved unit has fresh paint, vinyl floor, tile and upgraded showers in baths, and wash/dryer in the unit. It offers 2-bedrooms, 2-full baths, secured parking stall, useful lanai with rolling shades. Enjoy beautiful views of ocean, city and mountain. This Pet-Friendly building features a pool, gated community, party-room, additional storage, private yard and resident manager. Conveniently located in heart of Honolulu, near by Ala Moana Mall, Ward Center, Hospitals, Grocery Stores, freeway access and etc. **Sale Conditions:** None **Schools:** , , * [Request Showing](#), [Photos](#), [History](#), [Maps](#), [Deed](#), [Watch List](#), [Tax Info](#)

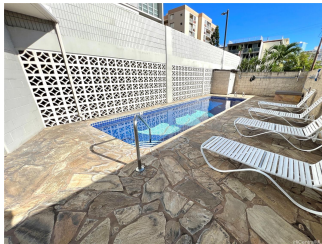

Address	Price	Bd & Bth	Living / Avg.	Land Avg.	Lanai	Occ.	FL	DOM
757 Kinalau Place 1503	\$398,000	2 & 2/0	786 \$506	27,748 \$14	78	76%	15	125

Address	Tax Maint. Ass.	Assessed Land	Assessed Building	Assessed Total	Ratio	Year & Remodeled
757 Kinalau Place 1503	\$104 \$934 \$0	\$69,400	\$385,600	\$455,000	87%	1975 & NA

[757 Kinalau Place 1503](#) - MLS#: [202400417](#) - Original price was \$428,000 - PRICE REDUCED! Motivated Sellers. One of the lowest 2/2/1 unit priced in the area! Only unit on the market in the building! Moving-in condition! Building plumbing and fire alarm had been updated recently. This improved unit has fresh paint, vinyl floor, tile and upgraded showers in baths, and wash/dryer in the unit. It offers 2-bedrooms, 2-full baths, secured parking stall, useful lanai with rolling shades. Enjoy beautiful views of ocean, city and mountain. This Pet-Friendly building features a pool, gated community, party-room, additional storage, private yard and resident manager. Conveniently located in heart of Honolulu, near by Ala Moana Mall, Ward Center, Hospitals, Grocery Stores, freeway access and etc. **Region:** Metro **Neighborhood:** Punchbowl-lower **Condition:** Above Average **Parking:** Assigned, Guest, Open - 1, Secured Entry, Street **Total Parking:** 1 **View:** City, Mountain, Ocean, Sunset **Frontage:** Pool: **Zoning:** 12 - A-2 Medium Density Apartme **Sale Conditions:** None **Schools:** , , * [Request Showing](#), [Photos](#), [History](#), [Maps](#), [Deed](#), [Watch List](#), [Tax Info](#)

DOM = Days on Market, Occ. = Occupancy, FL = Floor Number