

Executive Centre 1088 Bishop Street Unit 508, Honolulu 96813 * Executive Centre *

\$295,000

Beds: **1**

MLS#: **202401776, FS**

Year Built: **1984**

Bath: **1/0**

Status: **Active Under Contract**

Remodeled:

Living Sq. Ft.: **477**

List Date & DOM: **02-12-2024 & 86**

Total Parking: **1**

Land Sq. Ft.: **0**

Condition: **Above Average**

[Assessed Value](#)

Lanai Sq. Ft.: **0**

Frontage: **Other**

Building: **\$258,300**

Sq. Ft. Other: **0**

Tax/Year: **\$84/2024**

Land: **\$29,200**

Total Sq. Ft. **477**

Neighborhood: **Downtown**

Total: **\$287,500**

Maint./Assoc. **\$811 / \$0**

[Flood Zone](#): **Zone X - Tool**

Stories / CPR: **21+ / No**

Parking: **Assigned, Secured Entry**

Frontage: **Other**

[Zoning](#): **34 - BMX-4 Central Business Mix**

View: **City, Garden**

Public Remarks: Priced right and below appraised value of \$320,000 and just painted! Downtown Fee Simple, rarely available -08 unit with one reserved car parking on same floor. One Bedroom/One Bath zoned BMX-4 for multiple use options: residential, owner occupancy, long term rental, office/commercial use, and/or hotel use. Downtown district with treetop views of Tamarind Park and very close to: HPU, Banks, Grocery, Starbucks, 7-11, restaurants, shopping, post office, and bus lines. Amenities include Pool, Spa, Conference Room, Lobby/Lounge, Mailroom, Laundry Room. Longtime owner and well cared for.

Sale Conditions: None **Schools:** [Royal](#), , [Mckinley](#) * [Request Showing](#), [Photos](#), [History](#), [Maps](#), [Deed](#), [Watch List](#), [Tax Info](#)

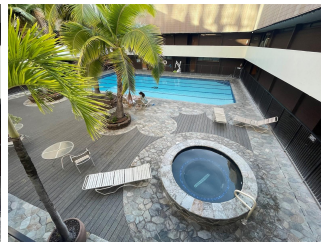
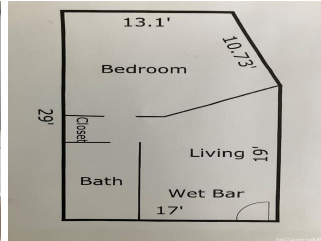

Address	Price	Bd & Bth	Living / Avg.	Land Avg.	Lanai	Occ.	FL	DOM
---------	-------	----------	---------------	-------------	-------	------	----	-----

1088 Bishop Street 508	\$295,000	1 & 1/0	477 \$618	0 \$inf	0	38%	5	86
--	---------------------------	---------	-------------	-----------	---	-----	---	----

Address	Tax Maint. Ass.	Assessed Land	Assessed Building	Assessed Total	Ratio	Year & Remodeled
1088 Bishop Street 508	\$84 \$811 \$0	\$29,200	\$258,300	\$287,500	103%	1984 & NA

<p>1088 Bishop Street 508 - MLS#: 202401776 - Priced right and below appraised value of \$320,000 and just painted! Downtown Fee Simple, rarely available -08 unit with one reserved car parking on same floor. One Bedroom/One Bath zoned BMX-4 for multiple use options: residential, owner occupancy, long term rental, office/commercial use, and/or hotel use. Downtown district with treetop views of Tamarind Park and very close to: HPU, Banks, Grocery, Starbucks, 7-11, restaurants, shopping, post office, and bus lines. Amenities include Pool, Spa, Conference Room, Lobby/Lounge, Mailroom, Laundry Room. Longtime owner and well cared for. Region: Metro Neighborhood: Downtown Condition: Above Average Parking: Assigned, Secured Entry Total Parking: 1 View: City, Garden Frontage: Other Pool: Zoning: 34 - BMX-4 Central Business Mix Sale Conditions: None Schools: Royal, , Mckinley * Request Showing, Photos, History, Maps, Deed, Watch List, Tax Info</p>						
--	--	--	--	--	--	--

DOM = Days on Market, Occ. = Occupancy, FL = Floor Number