

**86215 Leihoku Street, Waianae 96792 \* \$381,000 \* Originally \$448,100**

Sold Price: \$417,240	Sold Date: 10-17-2011	Sold Ratio: 110%
Beds: <b>3</b>	MLS#: <b>1101480, FS</b>	Year Built: <b>2011</b>
Bath: <b>2/1</b>	Status: <b>Sold</b>	Remodeled:
Living Sq. Ft.: <b>1,410</b>	List Date & DOM: <b>02-02-2011 &amp; 205</b>	Total Parking: <b>0</b>
Land Sq. Ft.: <b>5,093</b>	Condition: <b>Excellent</b>	<a href="#">Assessed Value</a>
Lanai Sq. Ft.: <b>0</b>	Frontage: <b>Other</b>	Building: <b>\$0</b>
Sq. Ft. Other: <b>0</b>	Tax/Year: <b>\$125/2009</b>	Land: <b>\$153,700</b>
Total Sq. Ft. <b>1,410</b>	Neighborhood:	Total: <b>\$153,700</b>
Maint./Assoc. <b>\$0 / \$0</b>	<a href="#">Flood Zone</a> : <b>Zone D - Tool</b>	Stories / CPR: <b>Two / No</b>
Parking: <b>Garage</b>	Frontage: <b>Other</b>	
<a href="#">Zoning</a> : <b>05 - R-5 Residential District</b>	View: <b>Mountain</b>	

**Public Remarks:** VA Delight. Ready to move in. Front Yard Landscaping is INCLUDED, backyard top soil, Builder offering \$10,000 credit to qualified buyers. Plus: Kitchen Granite Counter Top included (while supply lasts) No Homeowners' Dues, Solar Water Heater....An excellent opportunity,great views,perimeter fencing, dishwasher or washer/dryer, ceiling fans included **Sale Conditions:** Schools: [Leihoku](#), [Waianae](#), [Waianae](#) \* [Request Showing](#), [Photos](#), [History](#), [Maps](#), [Deed](#), [Watch List](#), [Tax Info](#)

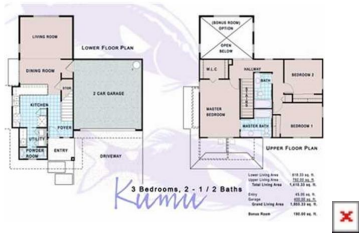

Address	Price	Bd & Bth	Living / Avg.	Land   Avg.	DOM
<a href="#">86215 Leihoku Street</a>	<b>\$381,000</b>	3 & 2/1	1,410   \$270	5,093   \$75	205

Address	Tax   Maint.   Ass.	Assessed Land	Assessed Building	Assessed Total	Ratio	Year & Remodeled
<a href="#">86215 Leihoku Street</a>	\$125   \$0   \$0	\$153,700	\$0	\$153,700	248%	2011 & NA

Address	Sold Price	Sold Date	Sold Ratio	Original Ratio	Sold Terms
<a href="#">86215 Leihoku Street</a>	\$417,240	10-17-2011	110%	93%	VA

**86215 Leihoku Street** - MLS#: [1101480](#) - Original price was \$448,100 - VA Delight. Ready to move in. Front Yard Landscaping is INCLUDED, backyard top soil, Builder offering \$10,000 credit to qualified buyers. Plus: Kitchen Granite Counter Top included (while supply lasts) No Homeowners' Dues, Solar Water Heater....An excellent opportunity,great views,perimeter fencing, dishwasher or washer/dryer, ceiling fans included **Region:** Leeward **Neighborhood:** **Condition:** Excellent **Parking:** Garage **Total Parking:** 0 **View:** Mountain **Frontage:** Other **Pool:** None **Zoning:** 05 - R-5 Residential District **Sale Conditions:** Schools: [Leihoku](#), [Waianae](#), [Waianae](#) \* [Request Showing](#), [Photos](#), [History](#), [Maps](#), [Deed](#), [Watch List](#), [Tax Info](#)

DOM = Days on Market