

86215 Leihoku Street, Waianae 96792 * \$381,000 * Originally \$448,100

Sold Price: \$417,240	Sold Date: 10-17-2011	Sold Ratio: 110%
Beds: 3	MLS#: 1101480, FS	Year Built: 2011
Bath: 2/1	Status: Sold	Remodeled:
Living Sq. Ft.: 1,410	List Date & DOM: 02-02-2011 & 205	Total Parking: 0
Land Sq. Ft.: 5,093	Condition: Excellent	Assessed Value
Lanai Sq. Ft.: 0	Frontage: Other	Building: \$0
Sq. Ft. Other: 0	Tax/Year: \$125/2009	Land: \$153,700
Total Sq. Ft. 1,410	Neighborhood:	Total: \$153,700
Maint./Assoc. \$0 / \$0	Flood Zone : Zone D - Tool	Stories / CPR: Two / No
Parking: Garage	Frontage: Other	
Zoning : 05 - R-5 Residential District	View: Mountain	

Public Remarks: VA Delight. Ready to move in. Front Yard Landscaping is INCLUDED, backyard top soil, Builder offering \$10,000 credit to qualified buyers. Plus: Kitchen Granite Counter Top included (while supply lasts) No Homeowners' Dues, Solar Water Heater....An excellent opportunity, great views, perimeter fencing, dishwasher or washer/dryer, ceiling fans included **Sale Conditions:** **Schools:** [Leihoku](#), [Waianae](#), [Waianae](#) * [Request Showing](#), [Photos](#), [History](#), [Maps](#), [Deed](#), [Watch List](#), [Tax Info](#)

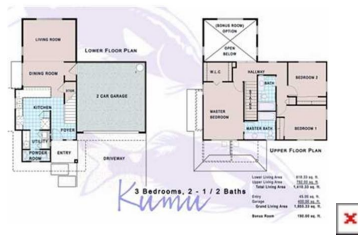

Address	Price	Bd & Bth	Living / Avg.	Land Avg.	DOM
86215 Leihoku Street	\$381,000	3 & 2/1	1,410 \$270	5,093 \$75	205

Address	Tax Maint. Ass.	Assessed Land	Assessed Building	Assessed Total	Ratio	Year & Remodeled
86215 Leihoku Street	\$125 \$0 \$0	\$153,700	\$0	\$153,700	248%	2011 & NA

Address	Sold Price	Sold Date	Sold Ratio	Original Ratio	Sold Terms
86215 Leihoku Street	\$417,240	10-17-2011	110%	93%	VA

[86215 Leihoku Street](#) - MLS#: [1101480](#) - Original price was \$448,100 - VA Delight. Ready to move in. Front Yard Landscaping is INCLUDED, backyard top soil, Builder offering \$10,000 credit to qualified buyers. Plus: Kitchen Granite Counter Top included (while supply lasts) No Homeowners' Dues, Solar Water Heater....An excellent opportunity, great views, perimeter fencing, dishwasher or washer/dryer, ceiling fans included **Region:** Leeward **Neighborhood:** **Condition:** Excellent **Parking:** Garage **Total Parking:** 0 **View:** Mountain **Frontage:** Other **Pool:** None **Zoning:** 05 - R-5 Residential District **Sale Conditions:** **Schools:** [Leihoku](#), [Waianae](#), [Waianae](#) * [Request Showing](#), [Photos](#), [History](#), [Maps](#), [Deed](#), [Watch List](#), [Tax Info](#)

DOM = Days on Market